

S.18, T.25N., R.43E., W.M., CITY OF SPOKANE, SPOKANE COUNTY, WASHINGTON
 SPOKANE PUBLIC FACILITIES DISTRICT
 CONVENTION CENTER COMPLEX
 TOPOGRAPHIC SURVEY

UTILITY	PURVEYOR	ADDRESS	CONTACT	PHONE NO.
WATER	CITY OF SPOKANE WATER DEPT.	914 E. Foothills Drive Spokane, WA 99207	LYNN SHUPE	(509) 625-7800
SEWER	CITY OF SPOKANE WASTEWATER MANAGEMENT DEPT.	909 E. Sprague Ave. Spokane, WA 99202	BILL PEACOCK	(509) 625-7900
GAS	AVISTA UTILITIES	1411 E. Mission Ave. Spokane, WA 99207	MARK HANSEN	(509) 495-4265
ELECTRIC	AVISTA UTILITIES	1411 E. Mission Ave. Spokane, WA 99207	MARIE RICHARDS	(509) 495-4183
TELECOM	AT&T	6046 E. Hayden Lake Rd. Hayden, ID 83835	WAYNE SHOUSE	(208) 762-2274
	COMCAST	1717 E. Buckeye Ave. Spokane, WA 99207	BRYAN RICHARDSON	(509) 755-4717
	CENTURYLINK	904 N. Columbus Spokane, WA 99202	CHARISSE MATHES	(509) 623-0309
	ZAYO FIBER SOLUTIONS	10905 E. Montgomery Dr. Spokane, WA 99206	DAN BARCOMB	(509) 688-4885

UTILITY STATEMENT

THE UNDERGROUND UTILITIES SHOWN HAVE BEEN LOCATED FROM FIELD SURVEY INFORMATION AND EXISTING DRAWINGS. THE SURVEYOR MAKES NO GUARANTEE THAT THE UNDERGROUND UTILITIES SHOWN COMPRISE ALL SUCH UTILITIES IN THE AREA, EITHER IN SERVICE OR ABANDONED. THE SURVEYOR FURTHER DOES NOT WARRANT THAT THE UNDERGROUND UTILITIES SHOWN ARE IN EXACT LOCATION INDICATED, ALTHOUGH HE DOES CERTIFY THAT THEY ARE LOCATED AS ACCURATELY AS POSSIBLE FROM INFORMATION AVAILABLE. THE SURVEYOR HAS NOT PHYSICALLY LOCATED THE UNDERGROUND UTILITIES.

ACCURACY STATEMENT

SURVEY PERFORMED USING A LEICA TCPR 1203 ONE SECOND ROBOTIC TOTAL STATION. FIELD TRAVERSE METHODS PER WAC 332-130-090 PART C.

NOTES

FIELD SURVEY COMPLETED IN SEPTEMBER 2012.
 CORNERS FOR PARCEL ARE DIMENSIONED AS FOUND IN THE FIELD.

TBM INFORMATION

- SET "X" ELEV = 1879.34 NAVD88
- SET "X" ELEV = 1881.46 NAVD88

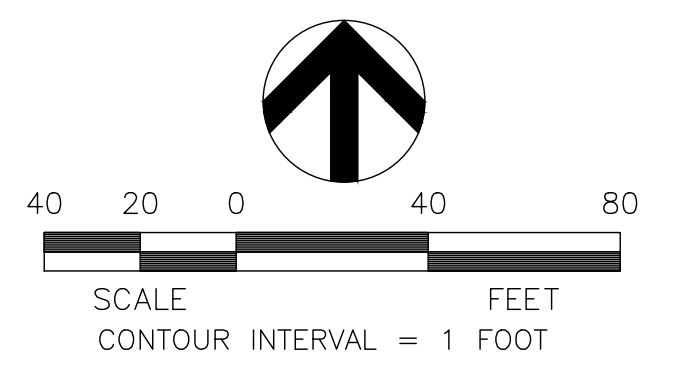

LEGEND

[Symbol]	BUILDING
[Symbol]	CONCRETE
[Symbol]	2' CONTOUR
[Symbol]	OVERHEAD BUILDING OUTLINE
[Symbol]	PROPERTY BOUNDARY
[Symbol]	RIGHT-OF-WAY
[Symbol]	TRAFFIC STRIPING
[Symbol]	CURB
[Symbol]	CONCRETE
[Symbol]	SIDEWALK
[Symbol]	WALL
[Symbol]	FENCE
[Symbol]	EDGE OF ASPHALT
[Symbol]	STORM
[Symbol]	SANITARY SEWER
[Symbol]	UNDERGROUND ELECTRICAL
[Symbol]	OVERHEAD ELECTRICAL
[Symbol]	NATURAL GAS
[Symbol]	WATER
[Symbol]	UNDERGROUND FIBER OPTIC
[Symbol]	OVERHEAD FIBER OPTIC
[Symbol]	TRAFFIC
[Symbol]	OVERHEAD TELEPHONE
[Symbol]	UNDERGROUND TELEPHONE
[Symbol]	OVERHEAD TELEVISION
[Symbol]	UNDERGROUND TELEVISION
[Symbol]	EXISTING WATER METER
[Symbol]	EXISTING WATER VALVE
[Symbol]	EXISTING FIRE DEPARTMENT CONNECTION
[Symbol]	EXISTING FIRE HYDRANT
[Symbol]	EXISTING POST INDICATOR VALVE
[Symbol]	EXISTING IRRIGATION CONTROL VALVE
[Symbol]	EXISTING WATER MANHOLE
[Symbol]	EXISTING MONITORING WELL
[Symbol]	EXISTING CLEAN OUT
[Symbol]	EXISTING SEWER MANHOLE
[Symbol]	EXISTING CATCH BASIN
[Symbol]	EXISTING DRYWELL
[Symbol]	EXISTING STORM MANHOLE
[Symbol]	EXISTING ELECTRIC BOX
[Symbol]	EXISTING ELECTRIC MANHOLE
[Symbol]	EXISTING CITY ANCHOR
[Symbol]	EXISTING POWER POLE
[Symbol]	EXISTING LIGHT
[Symbol]	EXISTING TRANSFORMER
[Symbol]	EXISTING POWER VAULT
[Symbol]	EXISTING JUNCTION BOX
[Symbol]	EXISTING UTILITY MANHOLE
[Symbol]	EXISTING CABLE TV BOX
[Symbol]	EXISTING TELEPHONE MANHOLE
[Symbol]	EXISTING TELEPHONE RISER
[Symbol]	EXISTING TRAFFIC SIGNAL VAULT
[Symbol]	EXISTING TRAFFIC MANHOLE
[Symbol]	EXISTING GAS METER
[Symbol]	EXISTING GAS VALVE
[Symbol]	EXISTING BOLLARD
[Symbol]	EXISTING CONIFEROUS TREE
[Symbol]	EXISTING DECIDUOUS TREE
[Symbol]	EXISTING PARKING METER
[Symbol]	EXISTING FENCE CORNER
[Symbol]	EXISTING POST
[Symbol]	EXISTING SIGN
[Symbol]	EXISTING DOUBLE POST SIGN
[Symbol]	EXISTING WHEELCHAIR STRIP
[Symbol]	EXISTING LEFT ARROW
[Symbol]	EXISTING STRAIGHT ARROW
[Symbol]	EXISTING CENTER TURN LANE ARROWS

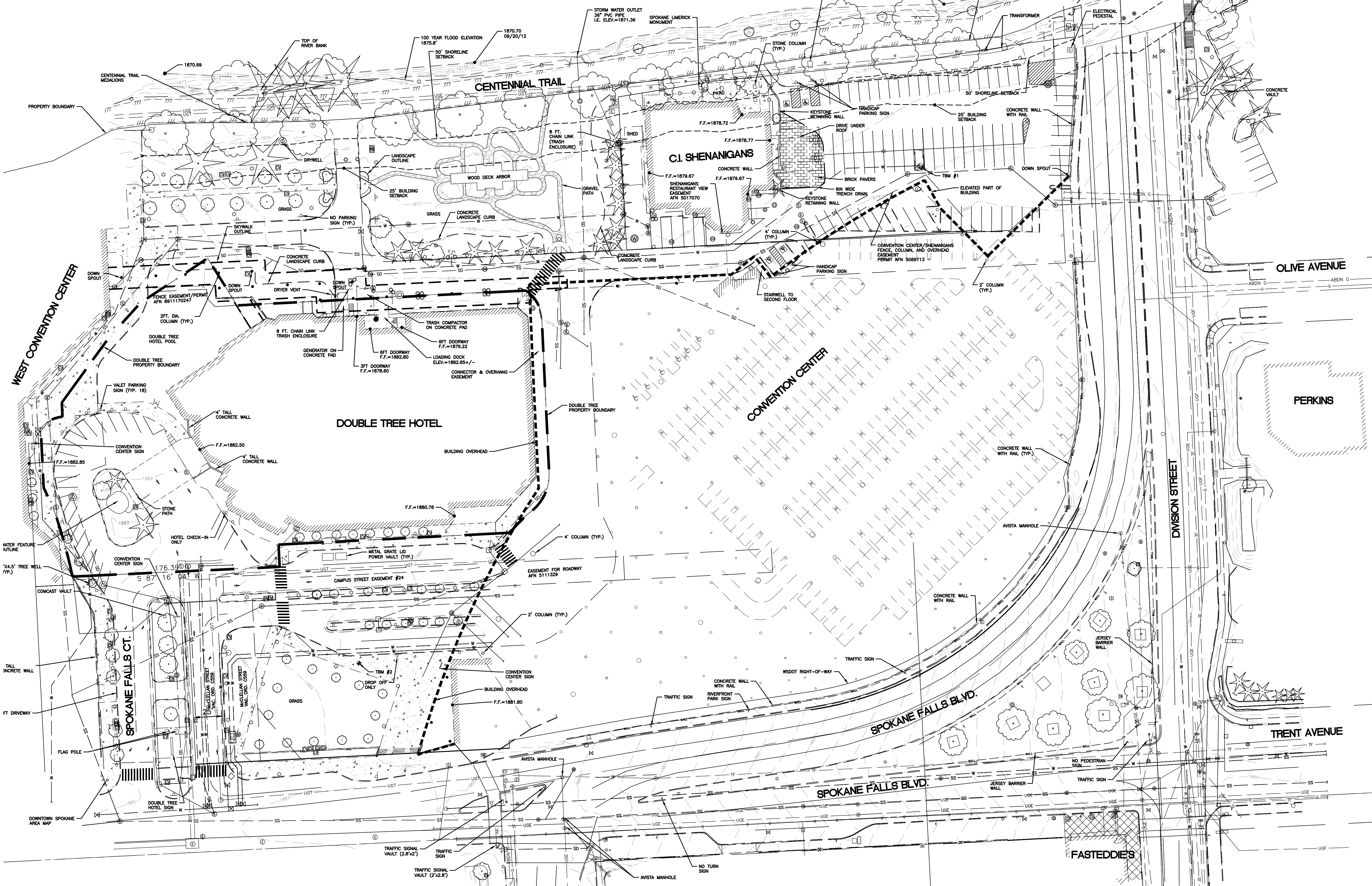

REVISIONS			
NO.	DATE	DESCRIPTION	BY

COFFMAN ENGINEERS
 10 N. Post Street Suite 500
 Spokane, Washington 99201
 Tel 509 328 2994
 Fax 509 328 2999

SPOKANE PUBLIC FACILITIES DISTRICT

DRAWING TITLE
**TOPOGRAPHIC SURVEY
 CONVENTION CENTER COMPLEX**

PROJECT NO. 12554	SCALE: 1" = 40'	DATE: 12/13/12	REVISION NO.
DESIGNED BY:	CHECKED BY:	DRAWING NO.	
DRAWN BY: JEA	REVIEWED BY: RCB	C1	