



Spokane

Convention Center Completion Study





PLAN DIAGRAMS

Description of Space**Program Area** (approx. sqft)**Public Lobbies, Concourses and Registration**

Public Lobbies & Entrances	7,270
Pre-Function Concourses	8,640
Existing Riverside / Prefunction (~ 16,700 sf)	0
Circulation / Riverside Elevator Relocation	340

Subtotal 16,250**Exhibition Halls**

Exhibit Hall, Upper Level	19,650
---------------------------	--------

Subtotal 19,650**Assembly Spaces**

Junior Ballroom (Flex-space)	13,700
Meeting Rooms	10,450
Board Room / Tasting	650

Subtotal 24,800**Front of House Support Areas****Subtotal 3,990****Back of House Service Areas****Subtotal 24,000****Vertical Circulation****Subtotal 1,530****Enclosed Building Area**

Total 91,500

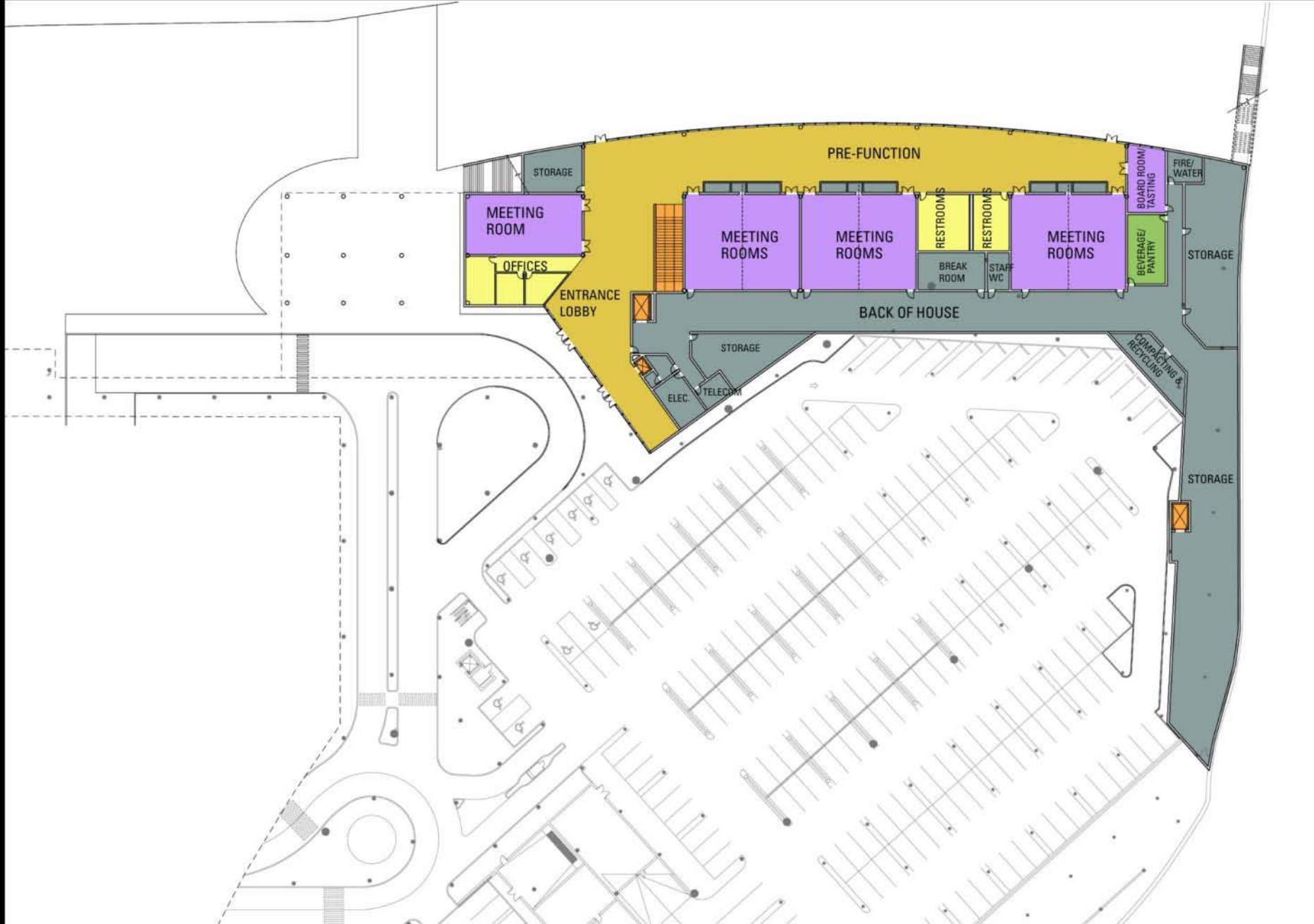

GROUND LEVEL PLAN



EXHIBIT LEVEL PLAN

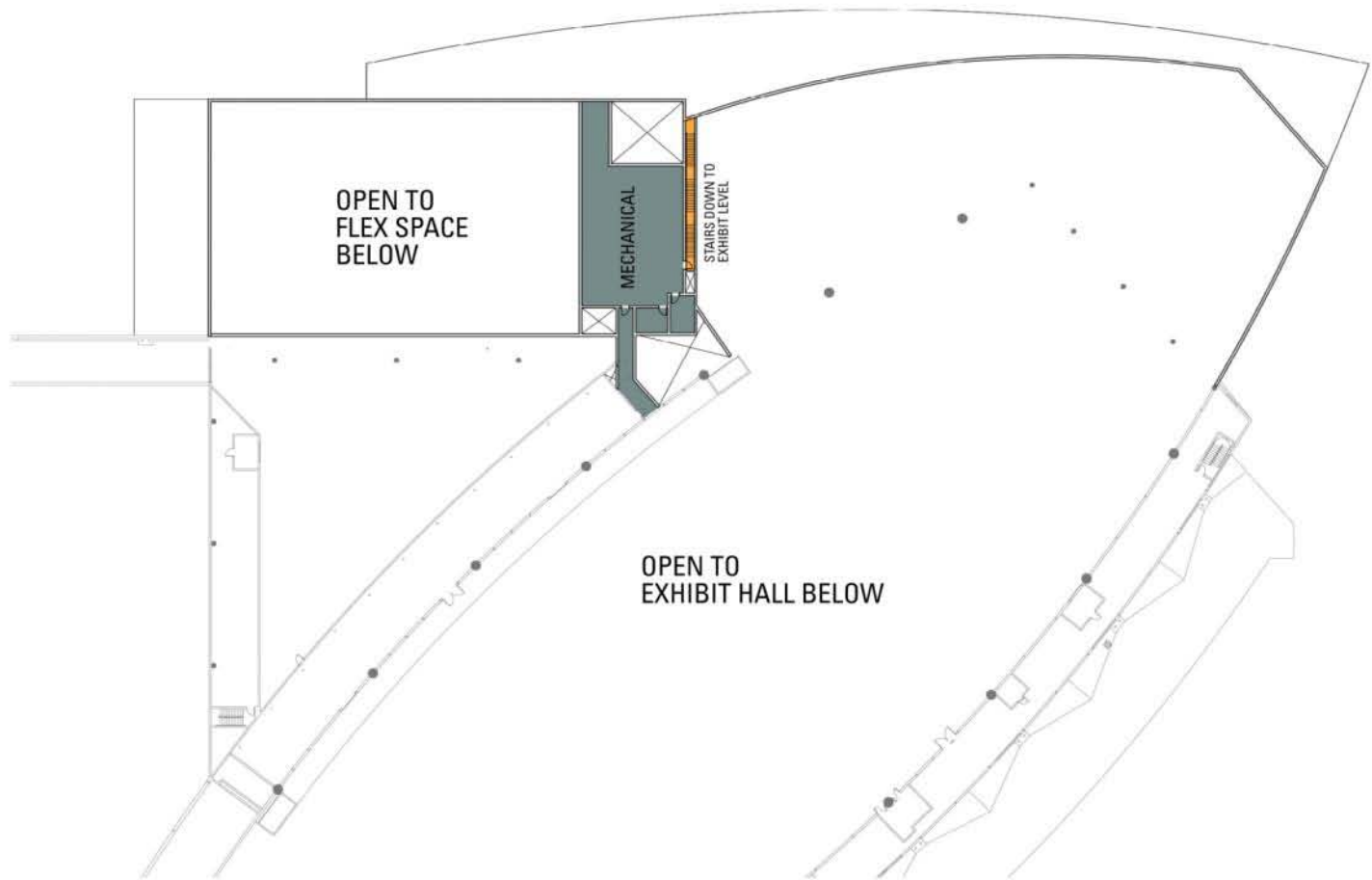

MEZZANINE LEVEL PLAN

PERSPECTIVE VIEWS



AERIAL VIEW LOOKING SOUTH



VIEW ALONG CENTENNIAL TRAIL LOOKING EAST



VIEW FROM DIVISION STREET BRIDGE LOOKING WEST

**OUTDOOR SPACES
&
LANDSCAPE**

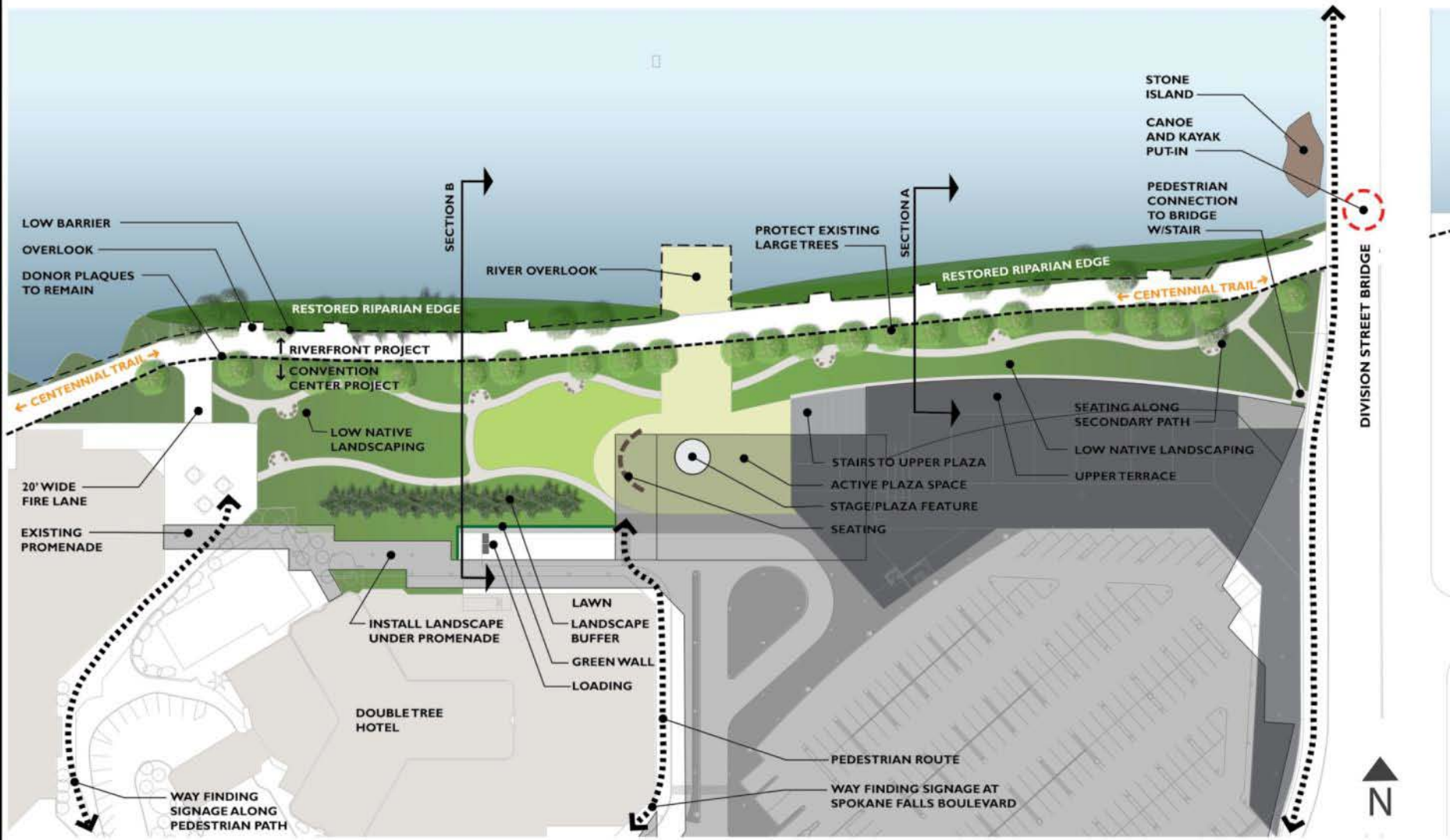

LANDSCAPE MASTER PLAN

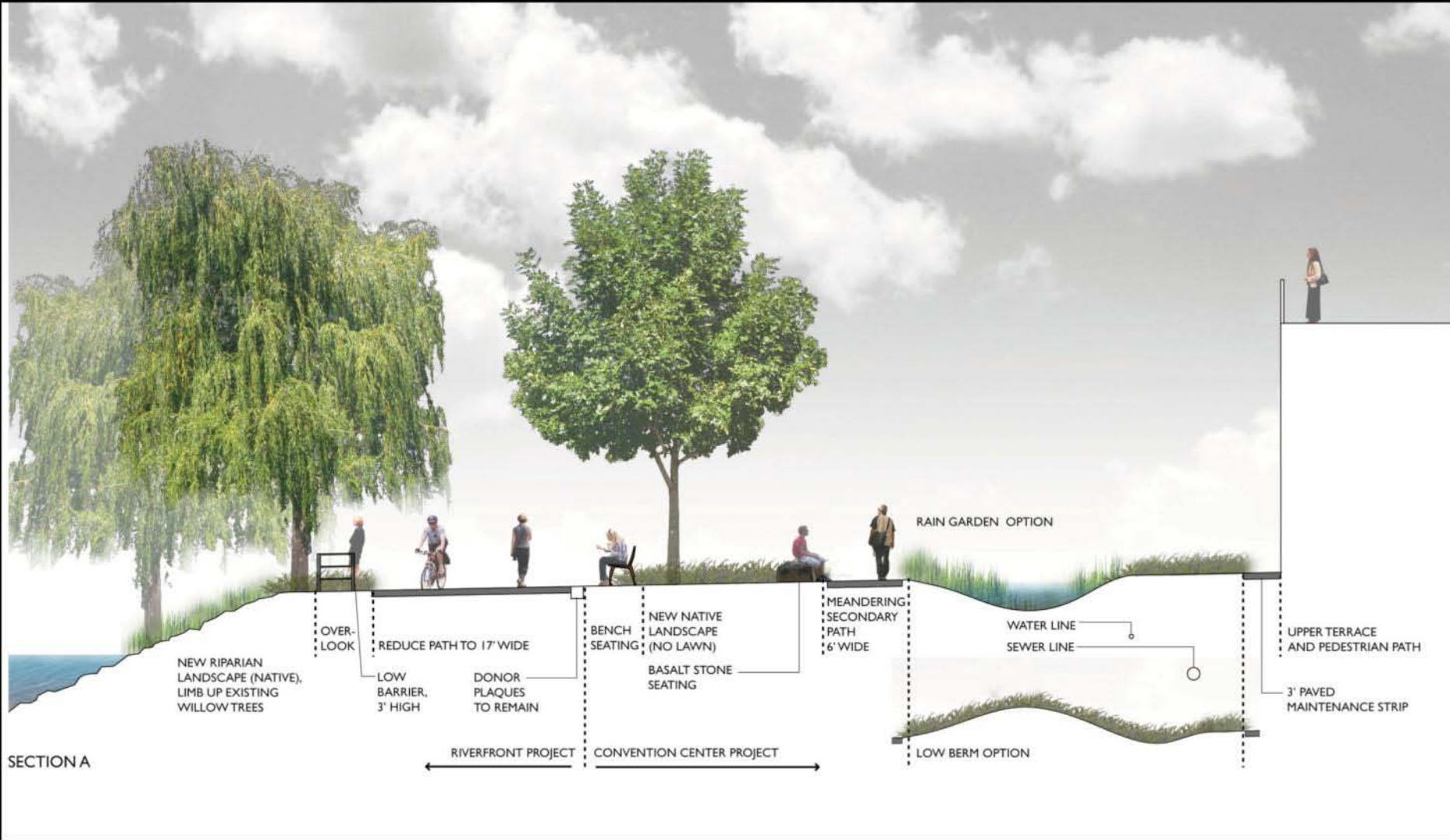

SECTION "A" -- AT ADDITION

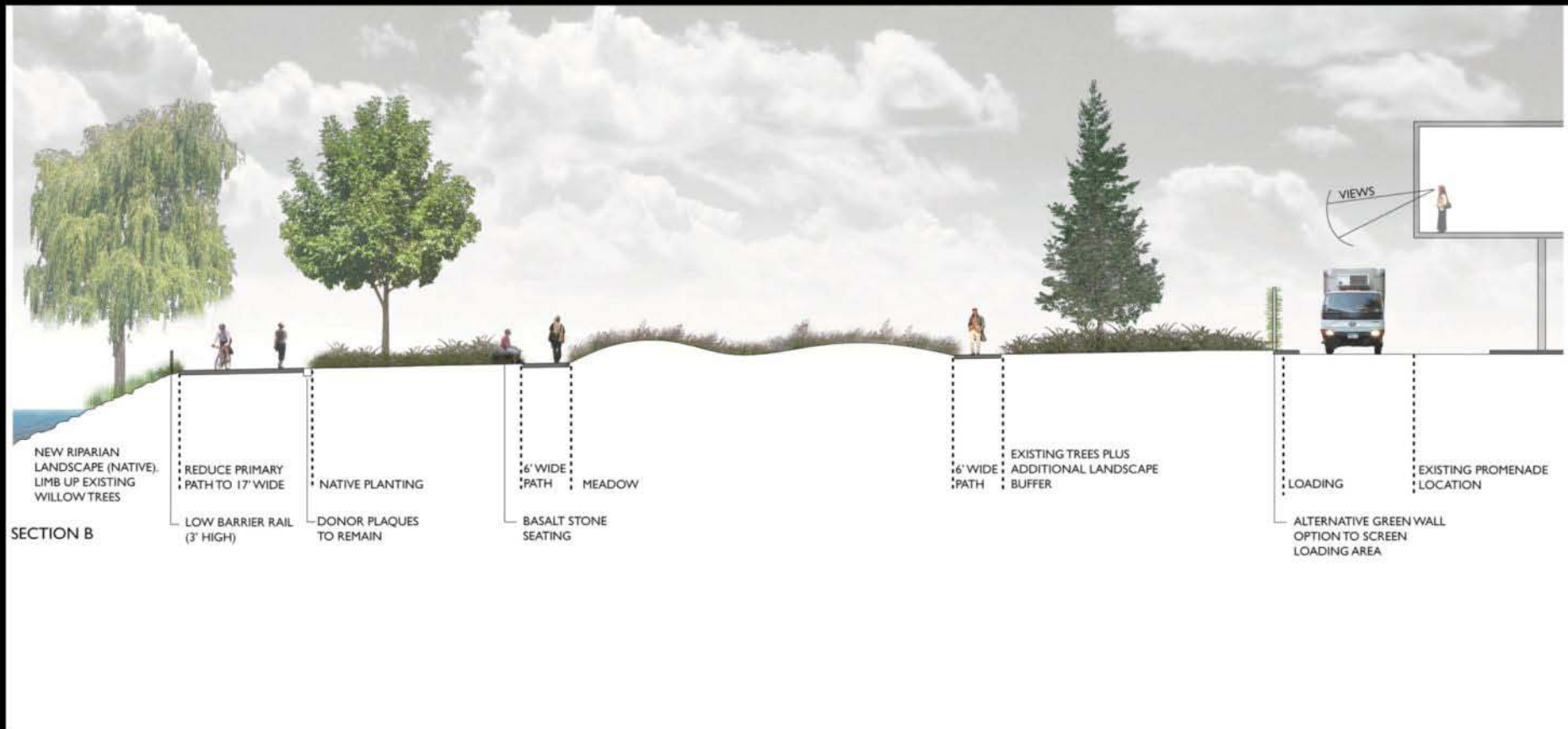

SECTION "B" -- AT PROMENADE / ARBOR